

# BLOOM TOWNSHIP SECTION 21 R12 TWP 11 MORGAN COUNTY, OH

## DALE F. SMITHVILLE 1ST ADD

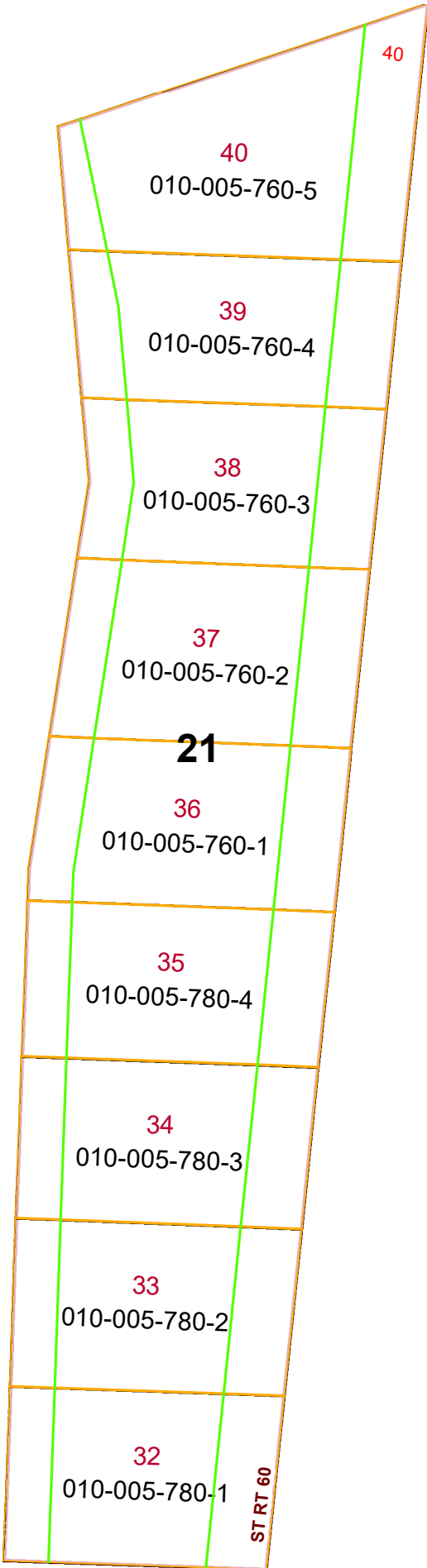

| PIN           | VOL   | PAG  | Owner                      | LegalDescr              |
|---------------|-------|------|----------------------------|-------------------------|
| 010-005-760-4 | OR151 | 618  | FOREMAN JOHN J & DEBORAH K | LOT 39 20,123.4 SQ FT D |
| 010-005-760-5 | OR151 | 618  | FOREMAN JOHN J & DEBORAH K | LOT 40 28,561.2 SQ FT D |
| 010-005-780-2 | OR89  | 577  | LONG KAREN L TRUSTEE       | LOT 33 20,113.9 SQ FT D |
| 010-005-780-3 | OR208 | 3323 | LONG KAREN L TRUSTEE       | LOT 34 20,157 SQ FT DA  |
| 010-005-780-4 | OR89  | 577  | ROWE DARRYL L & LINDA L    | LOT 35 20,057.6 SQ FT D |
| 010-005-760-1 | OR89  | 577  | ROWE DARRYL L & LINDA L    | LOT 36 21,424. SQ FT D  |
| 010-005-760-2 | OR104 | 429  | WHITE TRACY G              | LOT 37 22,758.6 SQ FT D |
| 010-005-760-3 | OR134 | 274  | WHITE TRACY G              | LOT 38 20,185.9 SQ FT D |
| 010-005-780-1 | OR204 | 320  | WILSON MARVIN L            | LOT 32 20,088.4 SQ FT D |

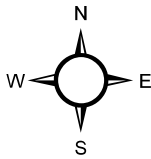

| Boundaries |          | Lot | Symbols |
|------------|----------|-----|---------|
|            | ROW      |     |         |
|            | Roads    |     |         |
|            | County   |     |         |
|            | Hidden   |     |         |
|            | Township |     |         |
|            | Section  |     |         |
|            | Sections |     |         |
|            | Parcels  |     |         |

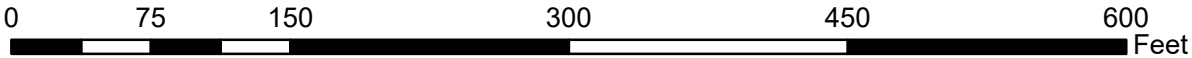

Disclaimer: The Information that these maps contains is for reference purposes only. Please bring any errors to the attention of the Engineer's Office staff.  
Thank You

Morgan County Engineer's Office  
Author: Marcia Wolfe  
Date: 7/21/2020